

# PHILADELPHIA PENNSYLVANIA

## Meetings:

- Meeting and banquet facilities available for up to 400 guests
- Well-trained staff provides personal assistance and attention to every detail
- Full-service catering with custom menus and impressive themed buffets
- Other available features include audio-visual equipment, staging, video conferencing, linen selection, centerpieces, dance floor, coat check, registration area, photography, entertainment, decorations, ice carvings, special lighting and much more
- Visit our website for a virtual tour of our meeting facilities

Room	Dimensions	Sq. Ft.	Ceiling Height	Reception	Banquet	Classroom	U-Shape	Theatre Style
GRAND BALLROOM	53' x 71'	3750 sq.ft.	17'	400	300	180	70	350
CRYSTAL BALLROOM	56' x 45'	2520 sq.ft.	9'	175	150	60	40	125
WARWICK	26' x 54'	1404 sq.ft.	9'	70	75	50	24	70
CHANCELLOR	20' x 37'	740 sq.ft.	9'	40	50	35	30	65
SPRUCE	31'6" x 17'	537 sq.ft.	7'4"	30	20	20	20	50
WALNUT	49'4" x 41'	2025 sq.ft.	7'4"	100	100	70	30	100
PINE	30'6" x 17'4"	532 sq.ft.	7'4"	30	30	18	15	30
JUNIPER	28'6" x 17'4"	498 sq.ft.	7'4"	30	30	18	15	36
CHESTNUT	47' x 49'6"	2331 sq.ft.	7'4"	150	130	100	36	125
CHERRY	44' x 17'	748 sq.ft.	7'4"	40	40	36	28	60

RESERVATIONS WORLDWIDE

[www.radisson.com](http://www.radisson.com)

1-800-333-3333

or call your travel pro

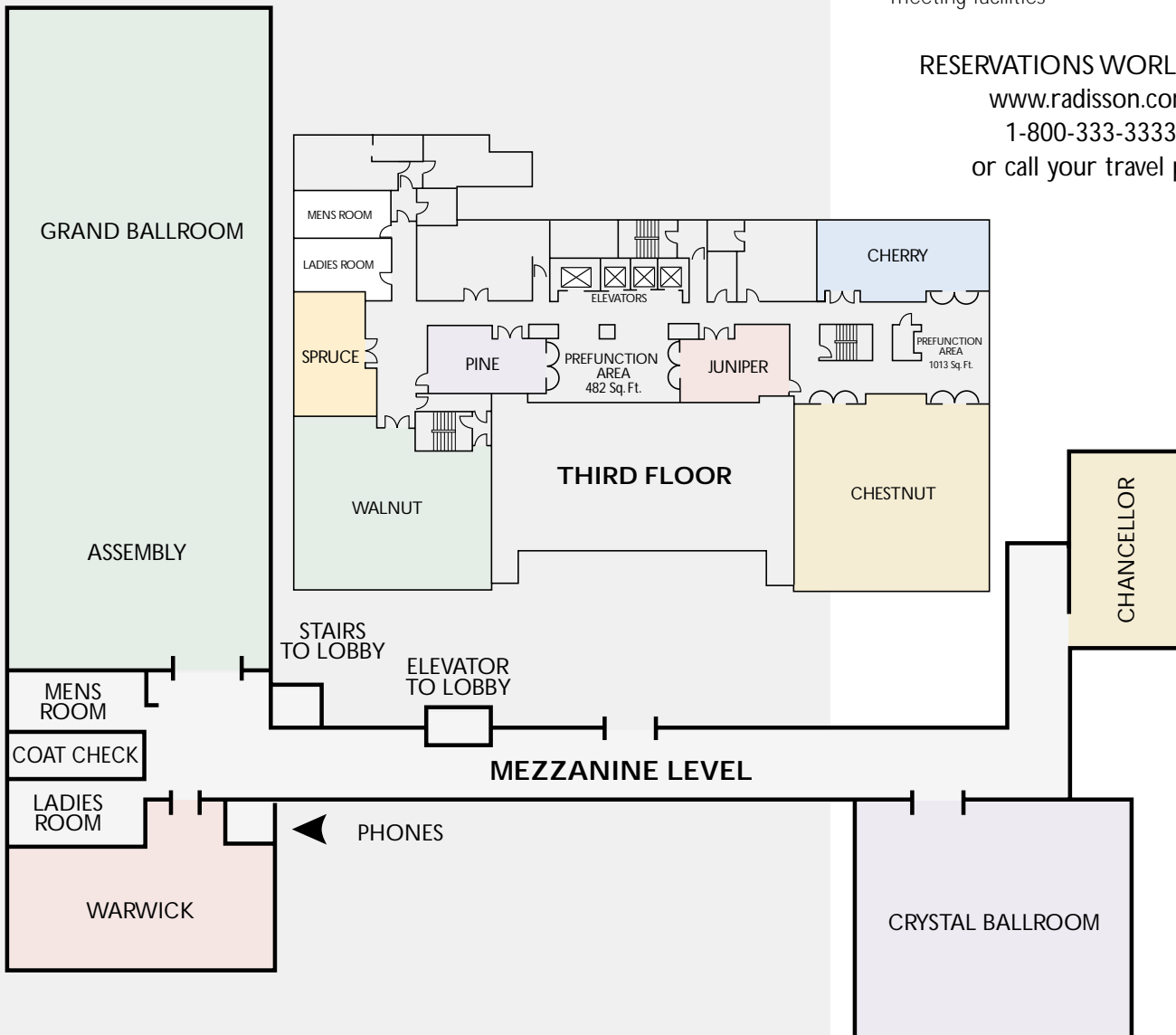

1701 Locust Street  
Philadelphia, PA 19103  
Telephone 1-215-735-6000  
Fax 1-215-790-7780  
[www.radisson.com/philadelphia](http://www.radisson.com/philadelphia)

